

# Operating instructions

## **TECHNIMAX** AS7

Cordless Hoover



**TechniSat**

## 1 Table of contents

<b>1</b>	<b>Table of contents .....</b>	<b>2</b>
<b>2</b>	<b>Foreword .....</b>	<b>3</b>
<b>3</b>	<b>Safety instructions .....</b>	<b>3</b>
3.1	Characters and symbols used .....	3
3.2	Intended use.....	4
3.3	Safe handling of the product.....	5
3.4	Legal information .....	8
3.5	Service instructions .....	8
<b>4</b>	<b>Description of the TECHNIMAX AS7 .....</b>	<b>9</b>
4.1	The scope of delivery .....	9
4.2	Device overview.....	11
4.2.1	Control panel .....	11
<b>5</b>	<b>Assembling the TECHNIMAX AS7 .....</b>	<b>12</b>
5.1	Attach / remove LED floor brush and aluminium suction tube.....	12
5.2	Attach / remove 2in1 combination and crevice nozzle.....	13
<b>6</b>	<b>First commissioning .....</b>	<b>13</b>
6.1	Storage stand/wall bracket .....	13
6.2	Charge battery.....	14
6.3	Remove battery .....	15
6.4	Charge battery separately .....	16
<b>7</b>	<b>Use .....</b>	<b>16</b>
7.1	LED floor brush.....	17
7.2	Damp mop attachment.....	18
7.3	Empty dust container.....	19
<b>8</b>	<b>Cleaning the cyclone unit, dust container and filter .....</b>	<b>20</b>
8.1	Cleaning the cyclone unit .....	20
8.2	Clean HEPA filter .....	22
8.3	Clean motor filter .....	23
8.4	Dismantling/cleaning the LED floor brush .....	24
8.4.1	Clean brush .....	25
<b>9</b>	<b>Troubleshooting .....</b>	<b>27</b>
<b>10</b>	<b>Technical data .....</b>	<b>29</b>
<b>11</b>	<b>Disposal instructions.....</b>	<b>31</b>

## 2 Foreword

### Dear customers,

Thank you for purchasing a TechniSat Hoover. These operating instructions are intended to help you familiarise yourself with the extensive functions of your new appliance and to make optimum use of them. It will help you to use the appliance safely and as intended. It is intended for anyone who installs, operates, cleans or disposes of the appliance.

Keep the operating instructions in a safe place for future reference.

You can find a current version of the operating instructions in the download area of your product on the TechniSat website  
[www.technisat.de](http://www.technisat.de).

We hope you enjoy using your TechniSat device!

Yours  
TechniSat Team

## 3 Safety instructions

### 3.1 Characters and symbols used



Indicates a safety instruction that can lead to serious injury or death if ignored. Observe the following signal words:

**DANGER** - Serious injuries with fatal consequences

**WARNING** - Serious injuries, possibly fatal

**ATTENTION** - Injuries



Indicates a note that you must observe to avoid device defects, data loss/misuse or unintentional operation. It also describes additional functions for your device.



Warning of electrical voltage. Follow all safety instructions to avoid electric shock. Never open the appliance.



Warning of explosive substances.



Indoor use - Appliances with this symbol are only suitable for indoor use.



Protection class II - Electrical appliances in protection class II are electrical appliances that have continuous double and/or reinforced insulation and no connection options for a protective conductor. The housing of an insulated electrical appliance of protection class II can partially or completely form the additional or reinforced insulation.



Your appliance bears the CE mark and fulfils all required EU standards.



Electronic devices/batteries should not be disposed of with household waste, but must be

- in accordance with Directive 2012/19/EU of the European Parliament and of the Council of

4 July 2012 on waste electrical and electronic equipment - must be disposed of properly. At the end of its service life, please dispose of this device at the designated public collection points. The battery must be removed before disposing of the device and disposed of separately from the device.



Observe all notes and safety instructions in these operating instructions. Keep the operating instructions in a safe place for future reference.



The power supply unit of your appliance corresponds to energy efficiency class VI.



This symbol indicates the polarity of the DC voltage at the hollow plug of the plug-in power supply unit.



Switching symbol for direct current.

## 32 Intended use

This appliance is intended for vacuuming normal household dust. Never vacuum the following items:

- Liquids or wet materials (e.g. wet carpet shampoo),
- glowing ashes, cigarette butts, matches, etc.,
- flammable or combustible substances,
- very fine dust (e.g. concrete dust), ash or toner,
- sharp, hard objects, e.g. large glass pliers.

The appliance is intended for private use and not for commercial use.

Only use the appliance as described in these operating instructions. Any other use is considered improper use.

The device may only be operated with the accessories supplied (power supply unit, BaGerien, cables, attachments, etc.). Any other use of these accessories is not permitted.

### 3.3 Safe handling of the product

Please observe the following instructions to minimise safety risks, avoid damage to the appliance and contribute to environmental protection.

Please read all safety instructions carefully and keep them for future reference.

Always follow all warnings and instructions in these operating instructions and on the back of the appliance.



#### **DANGER!**

##### **Risk of electric shock!**

- Only load and store in closed rooms.
- Do not use in rooms with high air humidity.
- If the appliance falls into water while it is connected to the mains, disconnect the power supply immediately. Only then pull the appliance out of the water!
- Never touch the appliance or the connecting cable with wet hands when these components are connected to the mains.
- Never vacuum up liquids. Do not pour any liquids into the dust container.
- Keep the motor unit away from moisture or wetness!
- If the appliance is to be used as a handheld hoover for cleaning a car, ensure that the appliance is not exposed to rain or moisture.



#### **WARNING!**

##### **Risk of injury!**

- Choking hazard! Keep children and animals away from the packaging material.
- Risk of strangulation! Ensure that the connecting cable is always out of reach of small children and animals.
- Risk of chemical burns! If the battery has leaked, avoid contact of skin, eyes and mucous membranes with the BaGeric acid. In the event of contact with BaGeric acid, rinse the affected areas immediately with plenty of clean water and seek medical assistance without delay.
- Danger of being sucked in! Keep animals, hair, jewellery, loose clothing, fingers and all other body parts away from the appliance nozzles. They could get stuck. If the hoover does get stuck, switch off the appliance immediately.
- Danger of falling! Ensure that the connecting cable does not pose a tripping hazard.



## **WARNING!**

### **Safety instructions in connection with lithium-ion batteries**

The device is equipped with a modern, powerful Li-ion rechargeable battery that meets all safety requirements. Due to the higher hazard potential of modern rechargeable batteries, please ensure that you handle the device and the rechargeable battery with care and observe the following safety instructions.

- The battery must not be taken apart, thrown into a fire, exposed to high temperatures above +40 °C, immersed in liquids or short-circuited. The battery could ignite or explode.
- Ensure that the motor unit and the battery cannot get wet.
- If possible, charge your device in a place with a smoke or fire alarm.
- Do not use the device if liquid has penetrated. The battery could ignite or explode.
- Do not cover the appliance or the power supply unit during charging to avoid a fire. Do not insert anything into the ventilation openings of the appliance and ensure that they are not blocked.
- Remove a leaking battery from the device immediately. Clean the contacts before inserting a new battery.
- Check the battery regularly for damage or deformation. A damaged/deformed battery must no longer be used.



Important note on the disposal of batteries/rechargeable batteries:

Batteries/rechargeable batteries may contain toxic substances that are harmful to the environment and must be disposed of separately from the device. For the chemical composition, please refer to the technical data or the imprint on the battery. It is therefore essential that you dispose of batteries in accordance with the applicable legal regulations. Never dispose of batteries in normal household waste. You can dispose of used BaSeries/batteries free of charge at your specialist dealer or at special disposal centres. For products with a battery compartment, you can remove the battery directly. If batteries are permanently installed, do not under any circumstances attempt to remove them yourself. In this case, contact the appropriate specialist personnel, e.g. a waste disposal company.



## **Attention!**

**Observe all the following instructions for the intended use of the appliance and to prevent appliance defects and personal injury.**

- This appliance can be used by children aged from 8 years and above and persons with reduced physical, sensory or mental capabilities or lack of experience and / or knowledge if they have been given supervision or instruction concerning use of the appliance in a safe way and understand the hazards involved.
- Children must not play with the appliance.
- Cleaning and user maintenance must not be carried out by children unless they are older than 8 years and are supervised.
- Children younger than 8 years and animals must be kept away from the appliance and the connecting cable.
- The appliance must always be disconnected from the power supply if it is not supervised and before assembly, disassembly or cleaning.
- Never immerse the appliance and the connecting cable in water or other liquids and ensure that they cannot fall into water or get wet.
- Only charge the battery using the mains adapter supplied.
- Do not charge any other devices with the mains adapter supplied.
- In the interests of your own safety, check the appliance for damage before each use. Only use the appliance if it is undamaged! If the appliance or the connecting cable is damaged, it must be replaced by the manufacturer, customer service or a similarly qualified person (e.g. a qualified electrician) in order to avoid hazards.

## **Risk of material and property damage**

- Ensure that the mains cable is not crushed, kinked or laid over sharp edges and does not come into contact with hot surfaces.
- Do not wrap the mains cable around the appliance or the power supply unit.
- Only use the appliance if it is completely and correctly assembled! The dust container and filters must be inserted and undamaged! If the dirt gets inside the motor unit, this could result in motor damage.
- Unplug the power supply unit from the socket if an error occurs during charging or before a gewiGer.
- The appliance must be switched off when the mains adapter is unplugged or plugged into the socket. Always pull the mains adapter and never the mains cable to disconnect the appliance from the mains!

- Do not use the device if it is still connected to the mains adapter.
- Never pull or carry the appliance by the power cable.
- Protect the device from heat, naked flames, extreme temperatures, prolonged damp, moisture and impact.
- Only use original accessories in order not to impair the operation of the appliance and to prevent possible damage. The LEDs are not interchangeable.

### 34 Legal information



TechniSat is not liable for product damage due to external influences, wear and tear or improper handling, unauthorised repairs, modifications or accidents.



Subject to changes and printing errors. Status 03/24.  
Reproduction and duplication only with the authorisation of the publisher. The latest version of the manual is available in PDF format in the download area of the TechniSat homepage at [www.technisat.de](http://www.technisat.de).



TECHNIMAX AS7 and TechniSat are registered trademarks of:

#### **TechniSat Digital GmbH**

TechniPark

Julius-Saxler-Straße 3

D-54550 Daun/Eifel

[www.technisat.de](http://www.technisat.de)



### 35 Service notes



This product is quality-tested and comes with a statutory warranty period of 24 months from the date of purchase. Please keep the invoice as proof of purchase. With  
For warranty claims, please contact the dealer of the product.



For questions and information or if there is a problem with this device, please contact our technical hotline:

Mon. - Fri. 8:00 - 18:00 under Tel.:  
03925/9220 1800.





Repair orders can also be ordered directly online at [www.technisat.de/reparatur](http://www.technisat.de/reparatur).



The illustrations used in these operating instructions may differ from the actual appliance. If you have any questions about the appliance or spare parts / accessories, please contact customer service.

If you need to return the device, please use only the following address:

TechniSat Digital GmbH  
Service Centre  
Nordstr. 4a  
39418 Staßfurt

The names of the companies, institutions or brands mentioned are trademarks or registered trademarks of their respective owners.

## 4 Description of the TECHNIMAX AS7

### 4.1 The scope of delivery

Please check that the scope of delivery is complete before commissioning:



Crevice nozzle



2in 1 Combi nozzle



Wall bracket



Power supply unit



LED floor brush



Aluminium suction pipe

1x aluminium suction  
tube 1x LED floor brush  
1x crevice nozzle (long)  
1x 2in1 combination nozzle (crevice nozzle, small and  
brush nozzle) 1x mains adapter  
1x wall bracket / stand Not shown

in the picture:

1x cyclone motor unit 1x  
battery  
1x damp wipe attachment + microfibre cloth

Description of the accessories:

The **LED floor brush** is suitable for both carpets and smooth floors. It has a rotating microfibre roller and is therefore particularly suitable for sensitive floors. The LEDs illuminate dark areas and highlight dirt for even more thorough cleaning. In combination with the **damp mop attachment** for cleaning suitable hard floors such as tiles or laminate/parquet.

The **2in1 combi nozzle** combines a small crevice and brush nozzle. Press the release button on the brush attachment and push it upwards at the same time to turn the crevice nozzle into a brush nozzle. The brush attachment must engage audibly:

- The **crevice nozzle** is suitable for upholstery, cleaning car interiors and all nooks and crannies.
- The **brush nozzle** is used for vacuuming upholstery and textiles and for removing dust from delicate objects such as picture frames, lampshades, keyboards, books, etc.

The **long crevice nozzle** is suitable for hard-to-reach areas such as corners, joints or niches.

The **aluminium suction pipe** ensures better accessibility to ceilings, corners, cupboard surfaces and, together with the LED floor brush, for floor cleaning. The suction pipe can be unlocked in the MiGe to reach hard-to-reach areas, e.g. under a bed frame.

**42 Device overview**

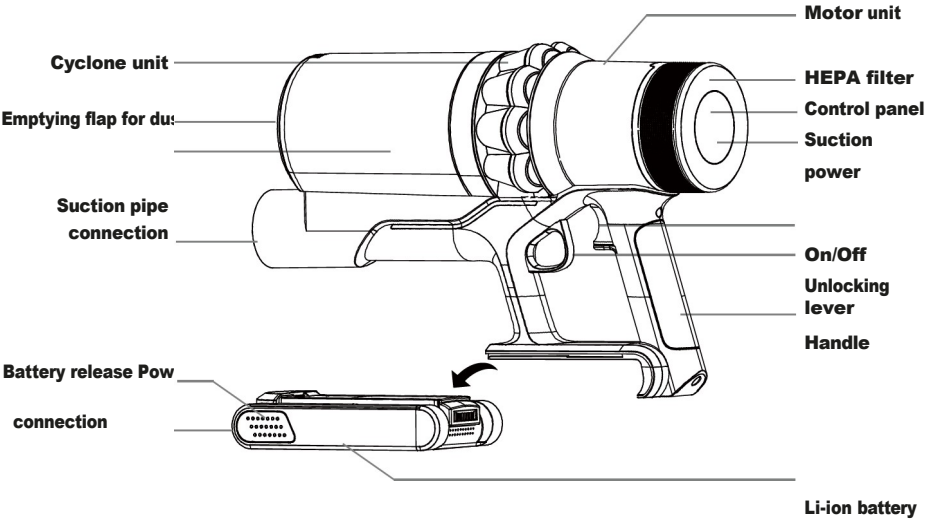

**421 Control panel**

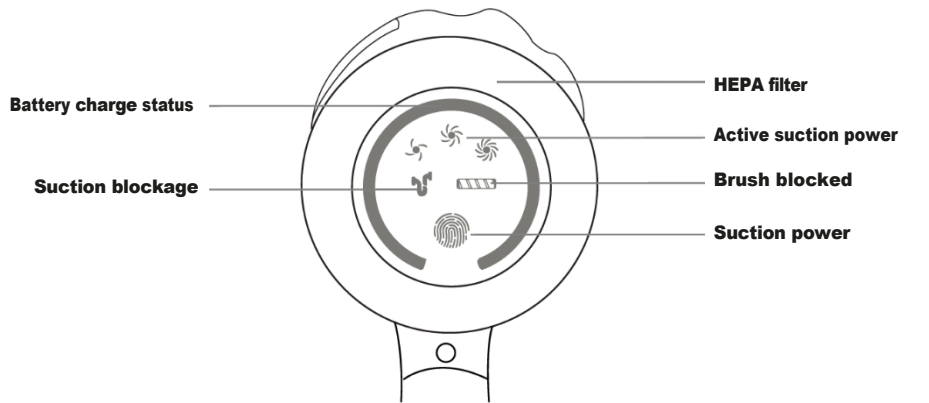

## 5 Assembling the TECHNIMAX AS7

### 5.1 Attach / remove LED floor brush and aluminium suction tube

Attach:

The **aluminium suction pipe** is inserted directly into the suction opening of the motor unit. It must engage audibly. Attach the **LED floor brush** to the aluminium suction tube in the same way.

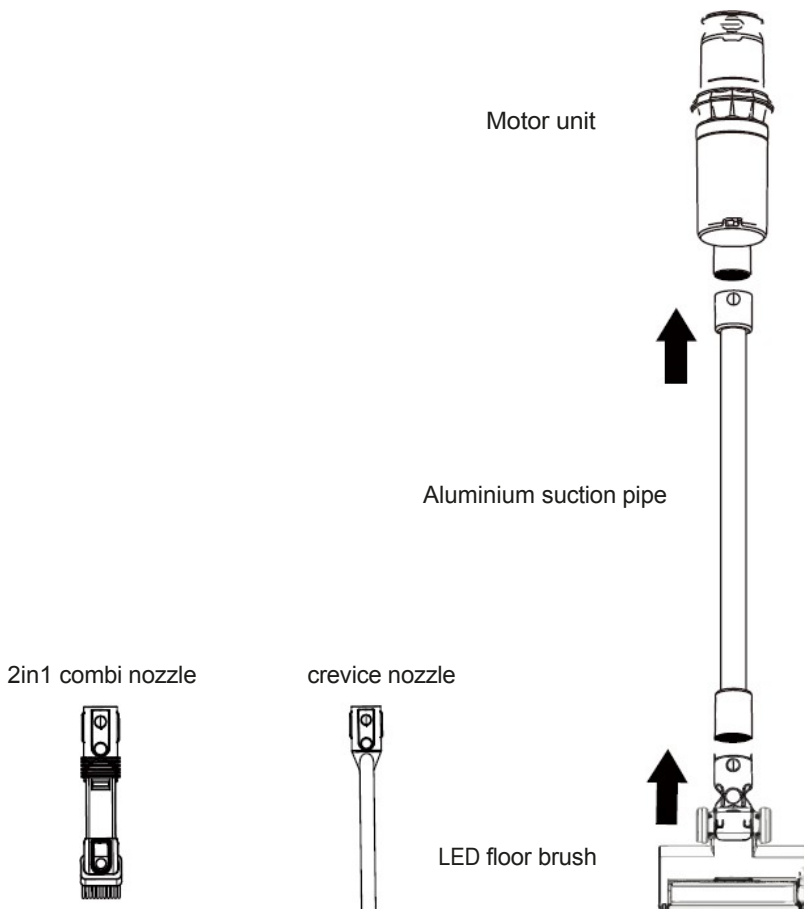

Lose weight:

Press the **release button** on the aluminium suction tube or the LED floor brush and pull out the LED floor brush or the aluminium suction tube at the same time.

## **52 Attach / remove 2in1 combination and crevice nozzle**

Attach:

Insert the desired nozzle into the suction opening of the motor unit or the aluminium suction pipe. The nozzle must engage audibly.

Lose weight:

Press the release button and pull out the respective nozzle at the same time.

## **6 First commissioning**

Please note the following points before first use:

- > Remove any foils, labels or transport protection from the appliance.  
Never remove the rating plate or any warning notices!
- > Charge the battery.
- > Set up the storage stand or mount the wall bracket.

### **6.1 Storage stand/wall bracket**

- > The battery can be charged individually, connected to the motor unit or in the storage stand/wall bracket. The storage stand/wall bracket has a recess for the hollow plug of the power supply unit. Lay the cable as shown in the illustration and then plug the power supply unit into the socket.

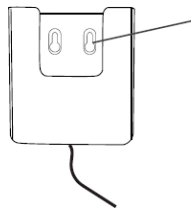
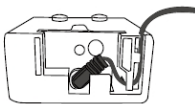

Holes for wall mounting

## 62 Charge battery



Fully charge the battery before first use. If the battery is discharged during use, it should be fully recharged before the next use. To reach the maximum battery capacity, the battery must first be charged and discharged several times.



Only connect the power supply unit to a properly installed socket that corresponds to the technical data of the appliance. The socket must also be easily accessible after connection so that the mains connection can be quickly disconnected.



Before inserting the battery, check that the contacts are clean and clean them if necessary.

- > Connect the battery to the motor unit by pushing the battery onto the motor unit until you hear it click into place.

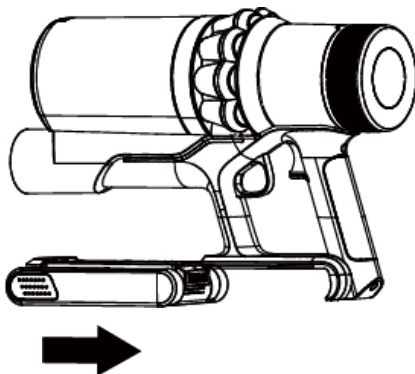

- > Slide the motor unit into the storage stand/wall bracket from above.

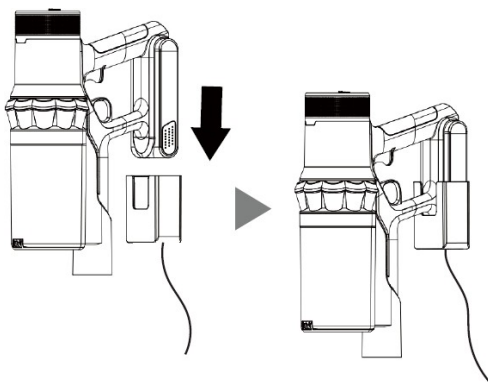

- > The charge status can now be read off the charge bar on the control panel.



The battery's charging electronics have overheating protection, which protects the battery from damage. Therefore, if you try to charge the battery after a long period of continuous operation (battery capacity is 0 - 10%), the charging process may start with a delay. If the battery is overheated, the charge status indicator flashes. Allow the battery to cool down before charging.



Alternatively, the battery can also be charged outside the storage stand/wall holder. Insert the hollow plug (DC connection) of the power supply unit into the connection socket on the battery and then plug the power supply unit into the socket. The charge status can now be read on the control panel using the charge bar.

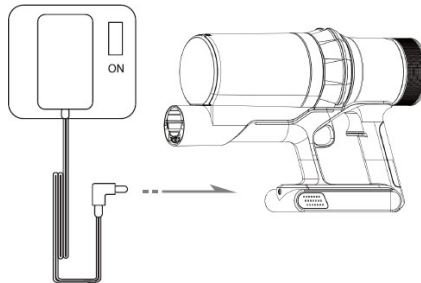

### 6.3 Remove battery

- > To remove the battery from the motor unit, first press the release button on the battery and simultaneously pull the battery forwards off the motor unit.

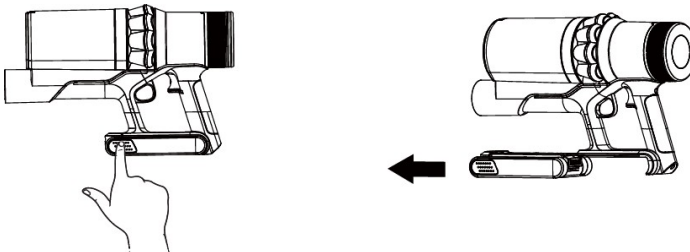

## 64 Charge battery separately

- > Insert the hollow plug (DC connection) of the power supply unit into the connection socket on the battery and then plug the power supply unit into the socket. The charging indicator light on the battery flashes green. The battery is being charged.

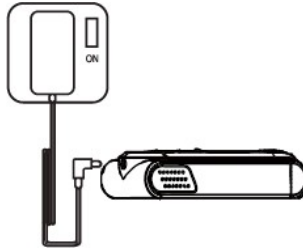

## 7 Utilisation

- i** Make sure that there are no large, sharp objects on the surface to be cleaned.
- i** Switch off the appliance after each cleaned surface to significantly increase the operating time per battery charge. Charge the battery after use.
- > Select accessories as required and attach them to the appliance.
- > Switch on the appliance by pressing the operating switch (on/off switch) once. The appliance starts the suction process immediately. The control panel lights up and shows the battery charge status and the suction power.
- > If necessary, the suction strength can be changed manually by selecting the "Suction power" is touched.

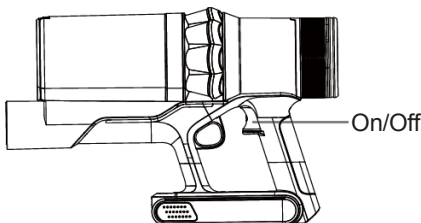

Suction power

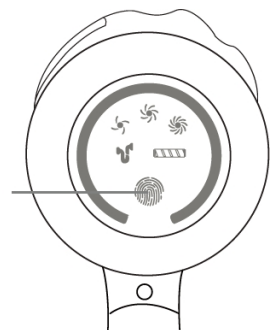



- > Move the appliance over the area to be cleaned.
- > If the appliance is to be switched off again, press the operating switch again.



Observe the MAX mark on the dust container. If the mark is reached during use, empty the dust container. Empty and clean the dust container after each use. The filters must also be cleaned regularly to avoid overloading the motor.

## 7.1 LED floor brush



The LED floor brush can be used to clean hard floors/floor coverings or short-pile carpets. Optionally, the damp mop attachment can also be used to clean hard floors.

- > The LED floor brush has a motorised brush unit and a dust trap felt that

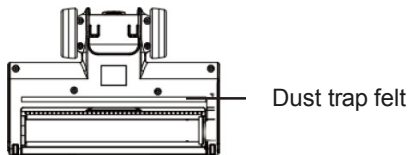

- > When vacuuming with the LED floor brush, make sure that there is dust/dirt in front of the floor brush. Therefore, do not try to remove dust/dirt that is behind the floor brush by to be sucked up. Proceed as shown to achieve optimum cleaning results:

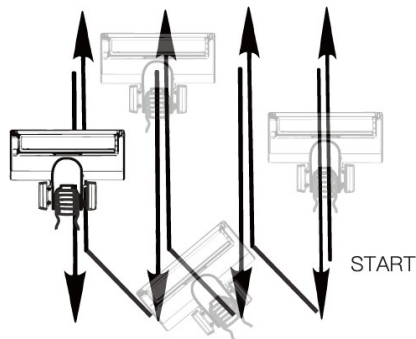

## 7.2 Damp wipe attachment

The LED floor brush can be fitted with the damp mop attachment to damp mop hard floors at the same time as vacuuming them.

- > Open the rubber seal on the top and fill the attachment with fresh water. If necessary, you can also use cleaning lubricant.



Only use a cleaning agent suitable for your floor and observe the mixing ratio enclosed with the cleaning agent.

- > Attach the microfibre cloth to the underside of the attachment (**1.**). Press it firmly onto the KleG strips (**2.**).
- > Click the LED floor brush into the damp mopping attachment until it clicks into place (**3.**).

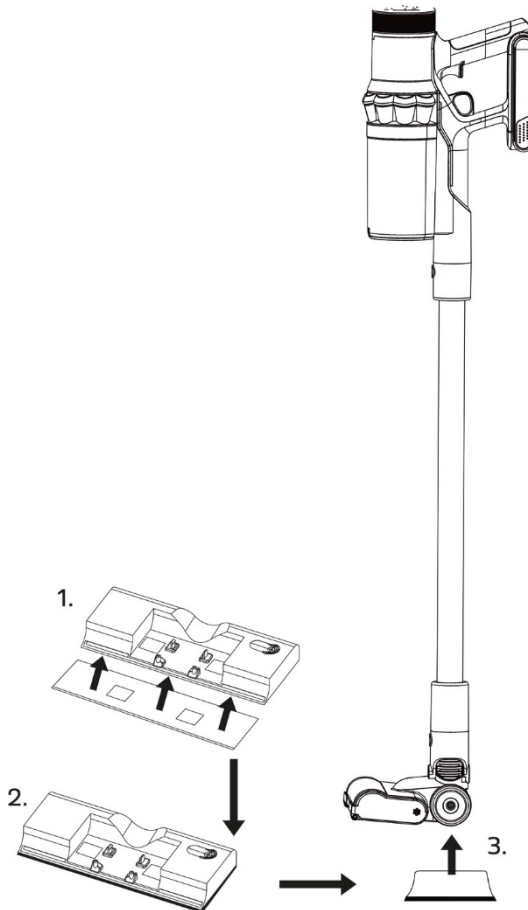

### 7.3 Empty dust container

- > Hold the dust container over an open waste bin. The distance to the dustbin should be as small as possible so that the dust does not spread into the surrounding area. Alternatively, the dust container can also be placed directly into a bin liner and closed with a rubber band.
- > Pull the release lever on the dust container gently to the first position. The lid of the dust container opens and the dirt falls out.

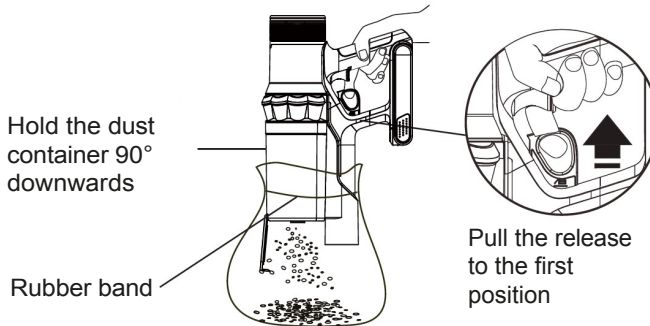

Hold the motor unit with the dust container vertically downwards so that the lid can open completely and the dust/dirt can fall out unhindered.

- > Press the lid onto the dust container to close it. The tab must audibly click into place.

## 8 Cleaning the cyclone unit, dust container and filter

### 8.1 Cleaning the cyclone unit

The cyclone unit should be brushed and/or cleaned under running water at regular intervals, depending on how dirty it is, or if the suction power is insufficient. Proceed as follows:

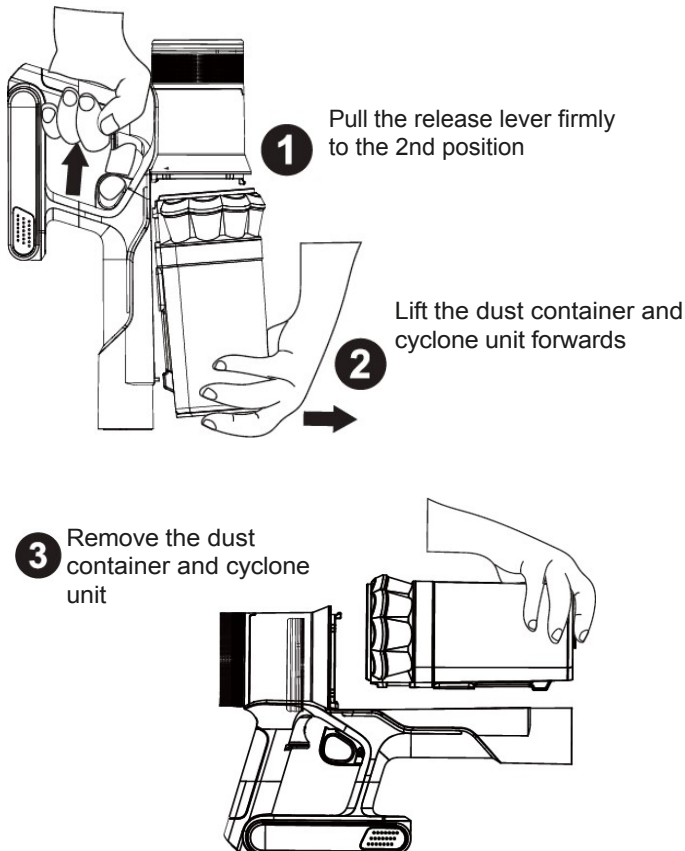

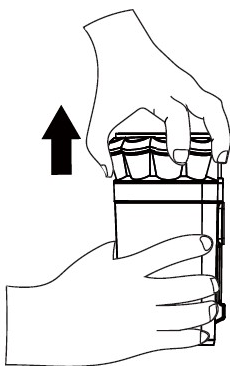

- 4** Remove the cyclone unit from the dust container

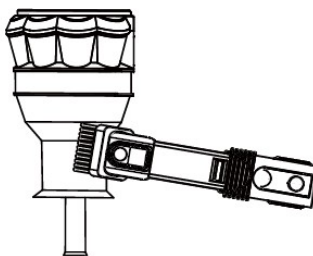

- 5** Remove coarse dirt residues or dust with a soft brush

- > If necessary, rinse the cyclone unit under cold, running water and then leave to dry in the air for at least 24 hours.

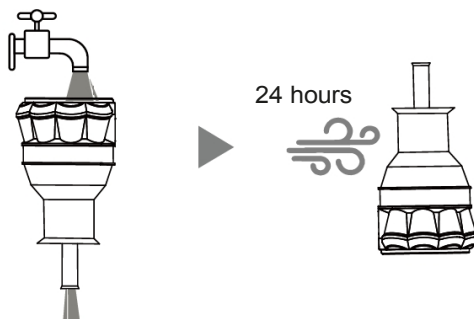

Never use a cyclone unit that is still damp or wet. This can destroy the motor unit.



Do not disassemble the cyclone unit any further than described here. The cyclone unit could be destroyed.

- > Proceed in reverse order to reassemble the cyclone unit and attach it to the motor unit.

## 82 Cleaning the HEPA filter

The HEPA filter should be cleaned every 3-6 months, depending on how dirty it is, or if the suction power is insufficient.

It is generally recommended to replace the filter with a new one every 6 months.

Proceed as follows:

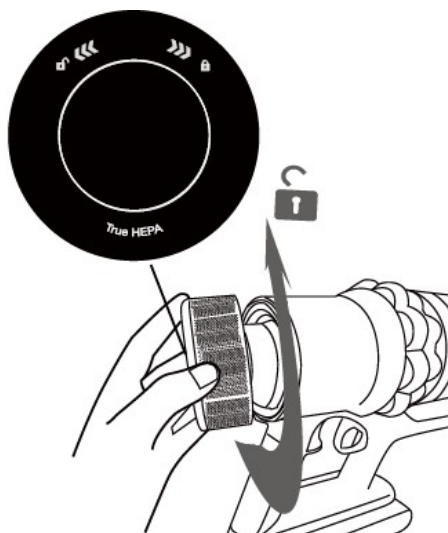

- 1 Turn the HEPA filter anti-clockwise and remove it from the motor unit

- > Remove coarse dirt residue and knock it out over a rubbish bin.
- > To reattach the HEPA filter to the motor unit, place it slightly offset on the motor unit and turn it clockwise to tighten.

### 8.3 Clean the motor filter

The motor filter should be cleaned under running water every 1-2 months, depending on how dirty it is, or if the suction power is insufficient.

Proceed as follows:



First remove the HEPA filter from the motor unit as described in chapter '8.2 Cleaning the HEPA filter' on page 22.

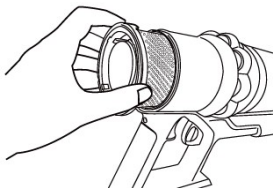

- 1** Pull the filter out of the motor unit

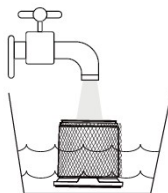

- 2** Clean the filter under cold, running water

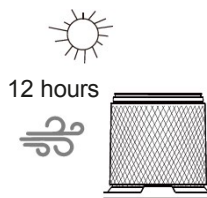

- 3** Leave the filter Dry



Do not clean the motor filter with a brush. This can damage the filter material.



Do not clean the motor filter under running water for longer than 10 minutes.



Never use a motor filter that is still damp or wet. This can destroy the motor unit.

- > Re-insert the motor filter into the motor unit in reverse order. Pay attention to the recess and the position of the guide rail. Then refit the HEPA filter on the motor unit.

#### 84 Dismantling/cleaning the LED floor brush

The LED floor brush should be cleaned from time to time. Hair in particular can become wrapped around the brush and the drive, causing the brush to fail and reducing the cleaning performance. To clean the brush, proceed as follows:

- > Slide the release backwards and hold it.

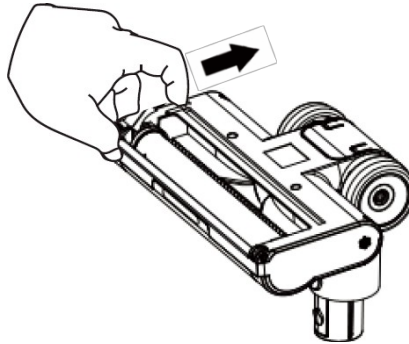

- > Remove the retaining bracket that holds the brush in the housing.

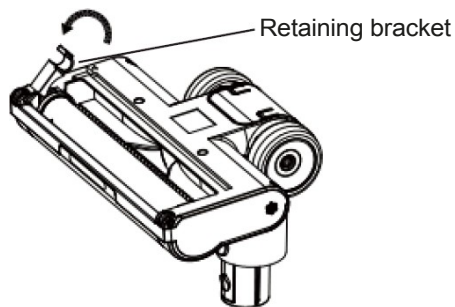



- > Remove the brush from the housing. To do this, first lift the right-hand side and then pull it out of the left-hand drive.

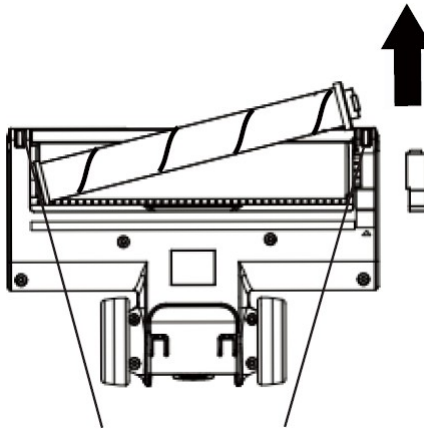

Remove any deposits on the small rollers with a brush.

#### **8.4.1 Cleaning the brush**

- > Remove the ball bearing cap. This is located on the side of the brush that is held in the housing by the retaining bracket.

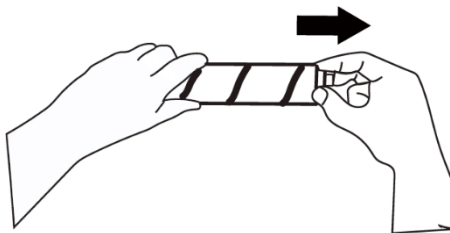

- > Oil the ball bearing and remove any dirt on the shaft.
- > Clean the brush carefully under running water. If hair is wrapped around the brush, carefully remove it with scissors, for example.

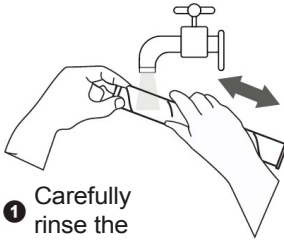

- 1** Carefully  
rinse the  
brush  
with water

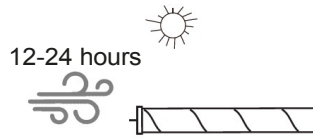

- 2** Allow the  
brush to dry

- > Reassemble the floor brush in reverse order.

## 9 Troubleshooting

If the appliance does not work properly, check whether the problem can be resolved yourself. If the problem cannot be solved with the above steps, contact customer service ("3.5 Service instructions" on page 8).



### **WARNING!**

#### **Risk of injury!**

Do not attempt to repair an electrical appliance yourself! Always contact the service centre in the event of defects ("3.5 Service instructions" on page 8).

<b>Problem</b>	<b>Possible cause</b>	<b>Solution</b>
The appliance works slowly or does not start.	The battery is empty.	Charge the battery.
Battery does not charge.	Battery protection against overcharging at charge level > 90%	Use the battery normally and then charge it.
	Battery overheated > Battery charge status indicator flashes green.	Allow the battery to cool down.
The suction power is too weak.	The battery is too weak.	Charge the battery.
	The dust container is too full.	Empty the dust container.
	The filters are dirty.	Clean the filters.
	The suction opening is blocked.	Switch off the appliance and remove the blockage.
	Particles that are too large or heavy can stick to the carpet.	Remove these foreign bodies by hand.

<b>Problem</b>	<b>Possible cause</b>	<b>Solution</b>
Dust escapes from the appliance when vacuuming.	Dust container or filter not seated correctly.	The seat of the dust container and filter. Ensure that the dust container is closed.
	The filters are dirty.	Clean the filters.
	The filters are worn or damaged.	Replace the filters.
The charging indicator light does not light up if the appliance is connected to the mains.	The power supply unit is not properly plugged into the socket or the hollow plug is not correctly inserted in the connection socket.	Correct the seat.
	The socket is defective.	Try a different socket.
Strange odour.	The device is used for the first time. Used for the first time.	When using the appliance for the first time, a new odour normal, it disappears over time.
The brush of the floor brush no longer rotates during the suction process.	Brush blocked or dirty.	Switch off the appliance, dismantle the floor brush and remove the dirt.
The engine noise changes.	The filters are dirty.	Clean the filters.
	The dust container is full.	Empty the dust container.

## 10 Technical data

Model	TECHNIMAX AS7
Power supply (via external power supply unit supplied)	AC-In: 100 - 240 V / 50/60 Hz DC-Out: 31 V / 0.5 A
Battery	Li-Ion 25.2 V / 2.5 Ah / 63 Wh
Suction power	380 W
Battery charging time (approx.)	4 - 5 hours
Operating time*	approx. 12 - 60 min.
HEPA filter	H13
Dimensions	Width floor brush: 24 cm Height kompleG: 111 cm Depth motor unit: 23 cm
Weight (motor unit)	1.6 kg

### Technical data of the supplied power supply unit

Manufacturer	TechniSat Digital GmbH, Julius-Saxler- Straße 3, D-54550 Daun
Model identifier	GQ18-310050-AG
Input voltage	AC 100 - 240 V
Input alternating current frequency	50/60 Hz
Output voltage	DC 31.0 V
Output current	0,5 A
Output power	15,5 W
Consistent efficiency in operation	84,3 %
Efficiency at low load (10%)	84,3 %
Power consumption at no load	0,1 W

\* The operating time is influenced by many factors such as the suction level used, the degree of soiling, battery status and the suction attachment used.

**Chemical composition of the battery**

Electrolyte salt and solvents.	Electrolytes	5-20 %
Lithium hexafluorophosphate	Electrolyte salt	0.05 - 5 %
Ethylene Carbonate Propylene Carbonate Diethyl Carbonate Ethyl propionate	Electrolyte solvent	5 - 20 %
Polyvinylidene fluorides	PVDF	< 1 %
Cu	Copper	3 - 15 %
Al	Aluminium	2 - 10 %
C	Graphite	10 - 30 %
LiCoO <sub>2</sub>	Lithium cobalt oxide	20 - 50 %

Technical changes and errors excepted.

## 11 Disposal instructions

The packaging of your appliance consists exclusively of recyclable materials. Please sort them accordingly and return them to the "Dual System". This product is labelled in accordance with Directive 2012/19/EU on waste electrical and electronic equipment (WEEE) and must not be disposed of with normal household waste at the end of its service life, but rather must be handed in at a collection point for the recycling of electrical and electronic equipment.



The symbol on the product, the instructions for use or the packaging indicates this.

The materials are recyclable according to their labelling. By reusing, material recycling or other forms of recycling old appliances, you are making an important contribution to protecting our environment.



Please ask your local authority for the responsible disposal centre. Ensure that empty batteries and electronic scrap are not disposed of with household waste, but disposed of properly (take back by specialist retailers, hazardous waste).



Important note on the disposal of batteries/rechargeable batteries:

Batteries/rechargeable batteries may contain toxic substances that are harmful to the environment and must be disposed of separately from the device. For the chemical composition, please refer to the technical data or the imprint on the battery.

It is therefore essential that you dispose of BaGeria/rechargeable batteries in accordance with the applicable legal regulations. Never dispose of batteries in normal household waste. You can dispose of used batteries free of charge at your specialist dealer or at special disposal centres.

For products with a battery compartment, you can remove the battery directly. If batteries are permanently installed, do not under any circumstances attempt to remove them yourself. In this case, contact the appropriate specialist personnel, e.g. a waste disposal company.

# Alles zu Ihrem TechniSat Produkt in einer App.

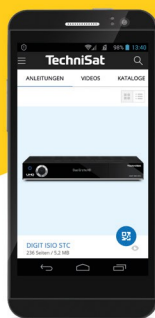

Bedienungs-  
anleitungen

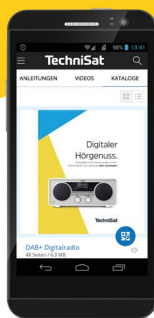

Kataloge/  
Prospekte

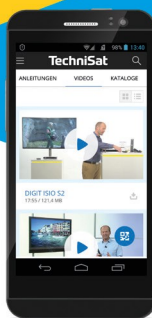

Informative  
Videos

Mit der INFODESK-App von TechniSat können Sie sich Bedienungsanleitungen, Kataloge, Prospekte und informative Produktvideos bequem und schnell auf dem Smartphone oder Tablet ansehen.



INFODESK QR-Code scannen  
und App kostenfrei für iOS oder  
Android herunterladen.



[www.technisat.de/infodesk](http://www.technisat.de/infodesk)

TechniSat Digital GmbH ist ein Unternehmen der  
Techniropa Holding GmbH und der LEPPER Stiftung.  
TechniPark · Julius-Saxler Straße 3 · 54550 Daun/Eifel

## TechniSat